

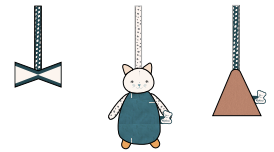

Âge recommandé :  
0-10 mois ou  
jusqu'à ce que le  
bébé se mette  
debout

Éléments de l'arche

Accessoires inclus

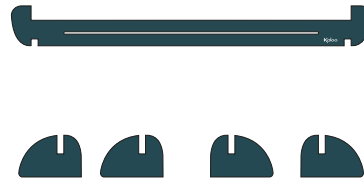
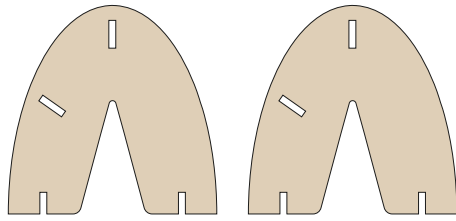

1

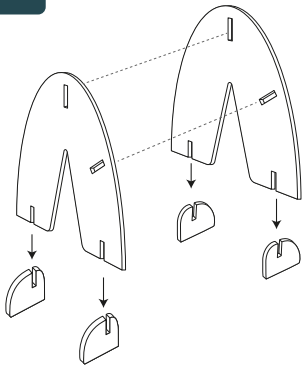

1. Positionnez les 2 panneaux pour que les encoches soient orientées vers vous.
2. Encastrez les 4 pieds dans les encoches en bas des panneaux jusqu'à ce qu'ils soient bien enclenchés et ne puissent tomber.
3. Posez l'ensemble debout face à face. Les pieds doivent être orientés vers l'extérieur.

2

### Position 1

Bébé couché sur le dos

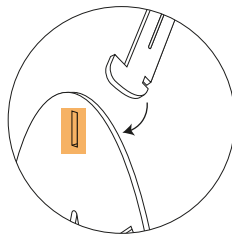

1. Inclinez la barre pour la glisser dans le trou supérieur du panneau.

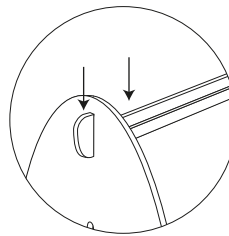

2. Appuyez vers le bas pour qu'elle soit bien stabilisée.

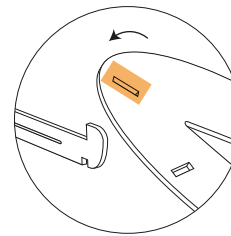

3. Inclinez l'autre panneau pour glisser la barre dans le trou supérieur.

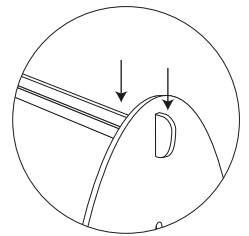

4. Appuyez la barre vers le bas pour qu'elle soit bien stabilisée.

3

### Position 2

Bébé couché sur le ventre ou assis

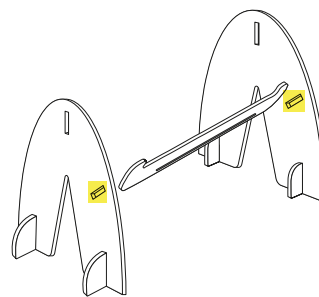

Reproduire les mêmes étapes que pour la **position 1** avec le trou inférieur comme sur les dessins.

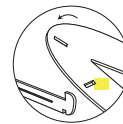
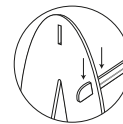
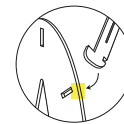

4

### Position 1

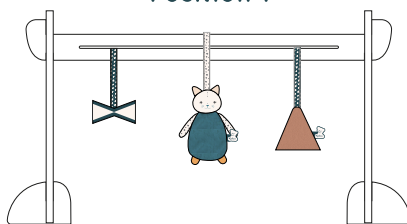

### Position 2

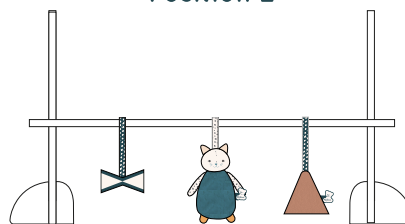

Attachez les accessoires à travers le trou de la barre grâce aux attaches velcros.



Pour déplacer l'arche facilement, tenez les panneaux et non la barre.



Components of the arch

Included accessories

Recommended age:  
0-10 months  
or until  
the baby  
stands up

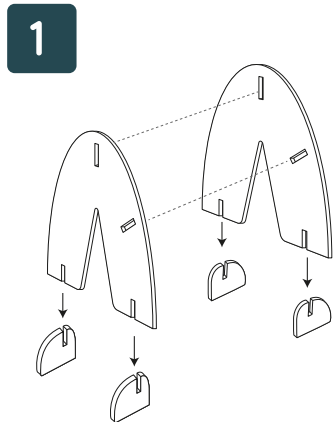
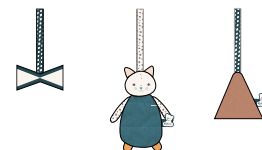
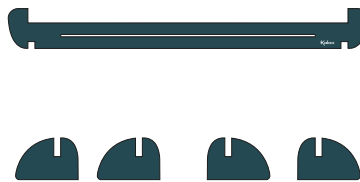
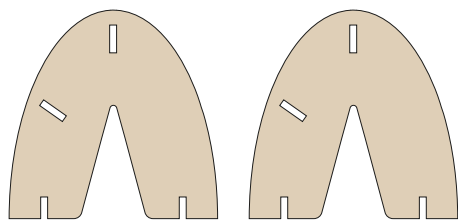

1. Position the 2 panels so that the notches are facing you.
2. Insert the 4 feet into the notches at the bottom of the panels until they are securely locked in place and can't fall out.
3. Place the panels upright, facing each other. The feet should face outwards.

### 2 Position 1

Baby lying on his back

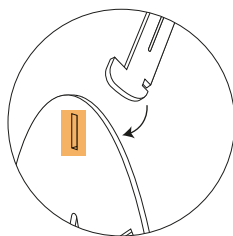

1. Tilt the bar to slide into the top hole of the panel.

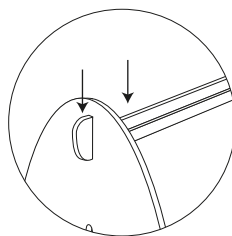

2. Press down so that it is well stabilised.

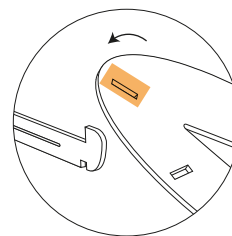

3. Tilt the other panel to slide the bar into the top hole.

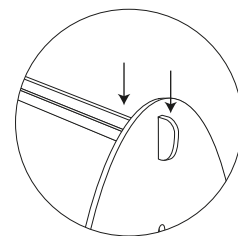

4. Press the bar down so that it is well stabilised.

### 3 Position 2

Baby lying on his chest or sitting up

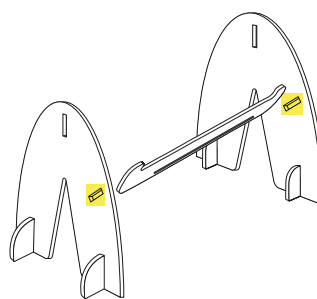

Repeat the same steps as for **position 1** with the lower hole as shown in the drawings.

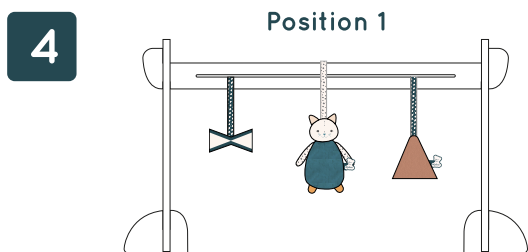
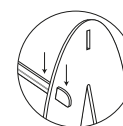
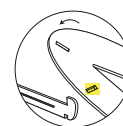

### Position 1

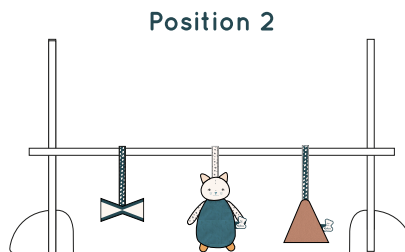

### Position 2

Attach the accessories through the hole in the bar with the velcro fasteners.



To move the arch easily, hold the panels and not the bar.



Età consigliata:  
da 0 a 10 mesi o  
fino a quando il  
bambino non è in  
grado di alzarsi da  
solo.

Elementi dell'arco

Accessori inclusi

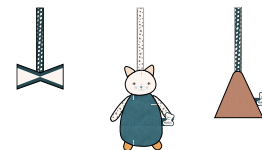
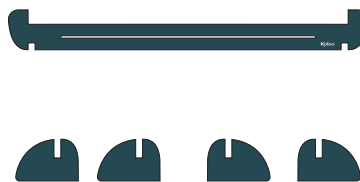
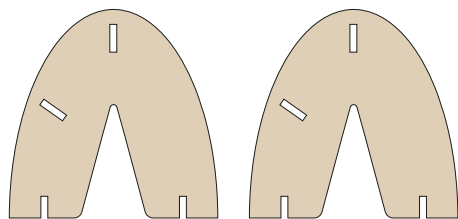

1

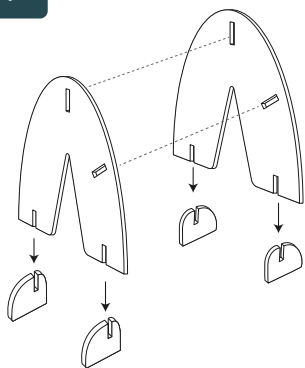

1. Posizionare i 2 pannelli in modo che le tacche siano rivolte verso di voi.
2. Inserire i 4 piedini nelle tacche alla base dei pannelli fino a quando non sono saldamente in posizione e non possono cadere.
3. Posizionare l'unità in verticale, una di fronte all'altra. I piedini devono essere rivolti verso l'esterno.

2

### Posizione 1

Il bambino è sdraiato sulla schiena

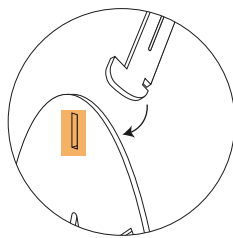

1. Inclinare la barra per farla scorrere nel foro superiore del pannello.

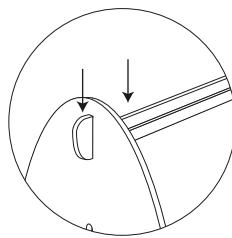

2. Premere verso il basso per stabilizzarla.

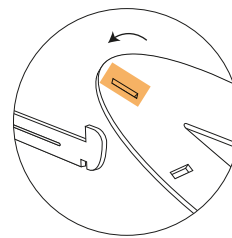

3. Inclinare l'altro pannello per far scorrere la barra nel foro superiore.

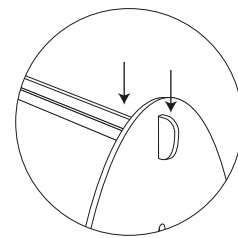

4. Premere la barra verso il basso per stabilizzarla.

3

### Posizione 2

Bambino sdraiato sulla pancia o seduto

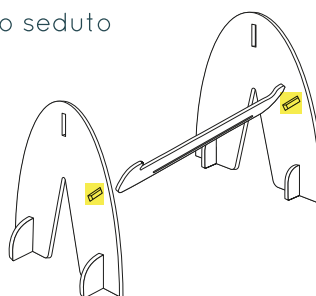

Ripetere le stesse operazioni della **posizione 1**, con il foro inferiore come indicato nel disegno.

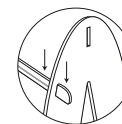
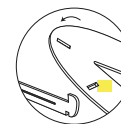
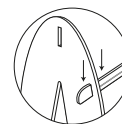
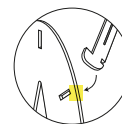

4

### Posizione 1

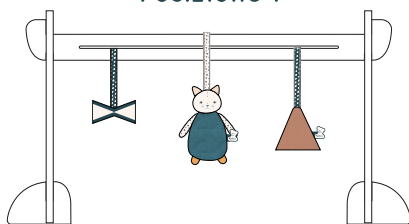

### Posizione 2

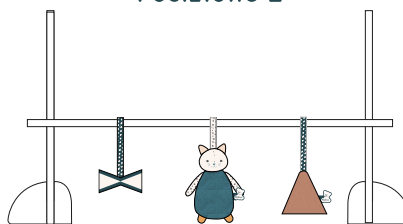

Fissare gli accessori attraverso il foro della barra utilizzando le chiusure in velcro.



Per spostare facilmente l'arco, tenere i pannelli e non la barra.



Edad recomendada:  
0-10 meses o hasta que el bebé pueda mantenerse erguido

Elementos de arco

Accesorios incluidos

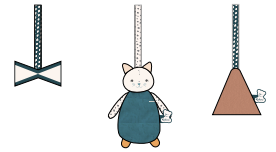
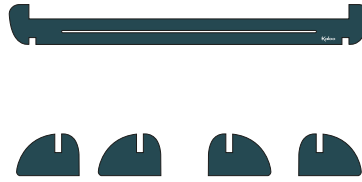
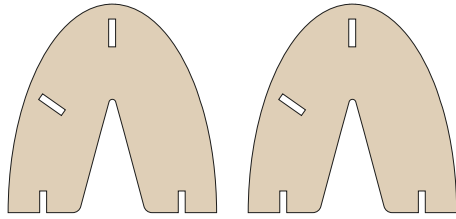

1

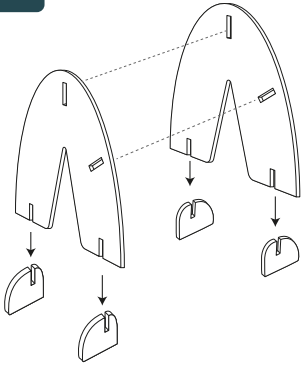

1. Coloque los 2 paneles de modo que las muescas queden orientadas hacia usted.
2. Introduzca los 4 pies en las muescas de la parte inferior de los paneles hasta que queden bloqueados y no puedan caerse.
3. Coloque la unidad en posición vertical, una frente a la otra. Las patas deben mirar hacia fuera.

2

### Posición 1

Bebé tumbado boca arriba

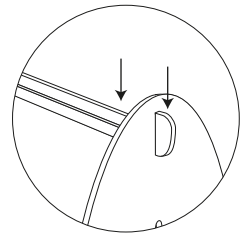
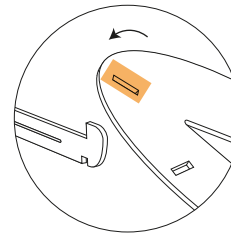
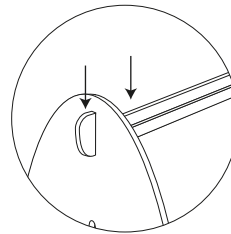
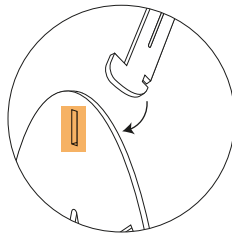

1. Incline la barra para introducirla en el orificio superior del panel.

2. Presione hacia abajo para estabilizar la barra.

3. Incline el otro panel para deslizar la barra en el orificio superior.

4. Presione la barra hacia abajo para estabilizarla.

3

### Posición 2

Bebé tumbado boca abajo o sentado

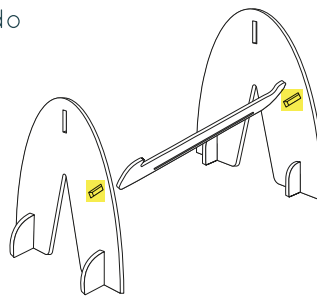

Repita los mismos pasos que para la **posición 1** con el orificio inferior como se muestra en el dibujo.

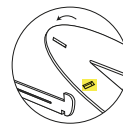
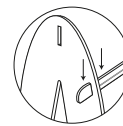

4

### Posición 1

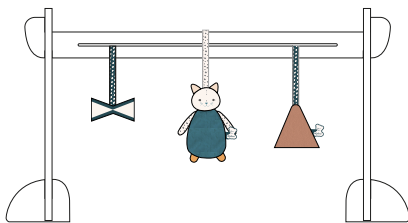

### Posición 2

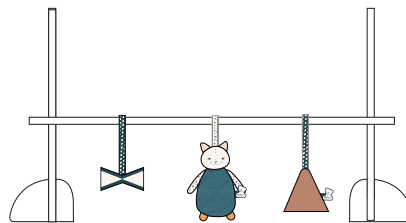

Fije los accesorios a través del orificio de la barra utilizando los cierres de velcro.



Para mover el arco con facilidad, sujete los paneles y no la barra.